

SCREEN DOOR

MEASUREMENTS & INSTALLATION INSTRUCTIONS



- 1 ALUMINIUM PROFILES**
- 2 SCREEN**
- 3 HINGES**
- 4 HINGE PINS**
- 5 SPRING**
- 6 SCREWS**
- 7 HANDLE**
- 8 MAGNET BAND**

PRODUCT FEATURES:

Maximum width of the door is 1300 mm.
Maximum height of the door is 2400 mm.

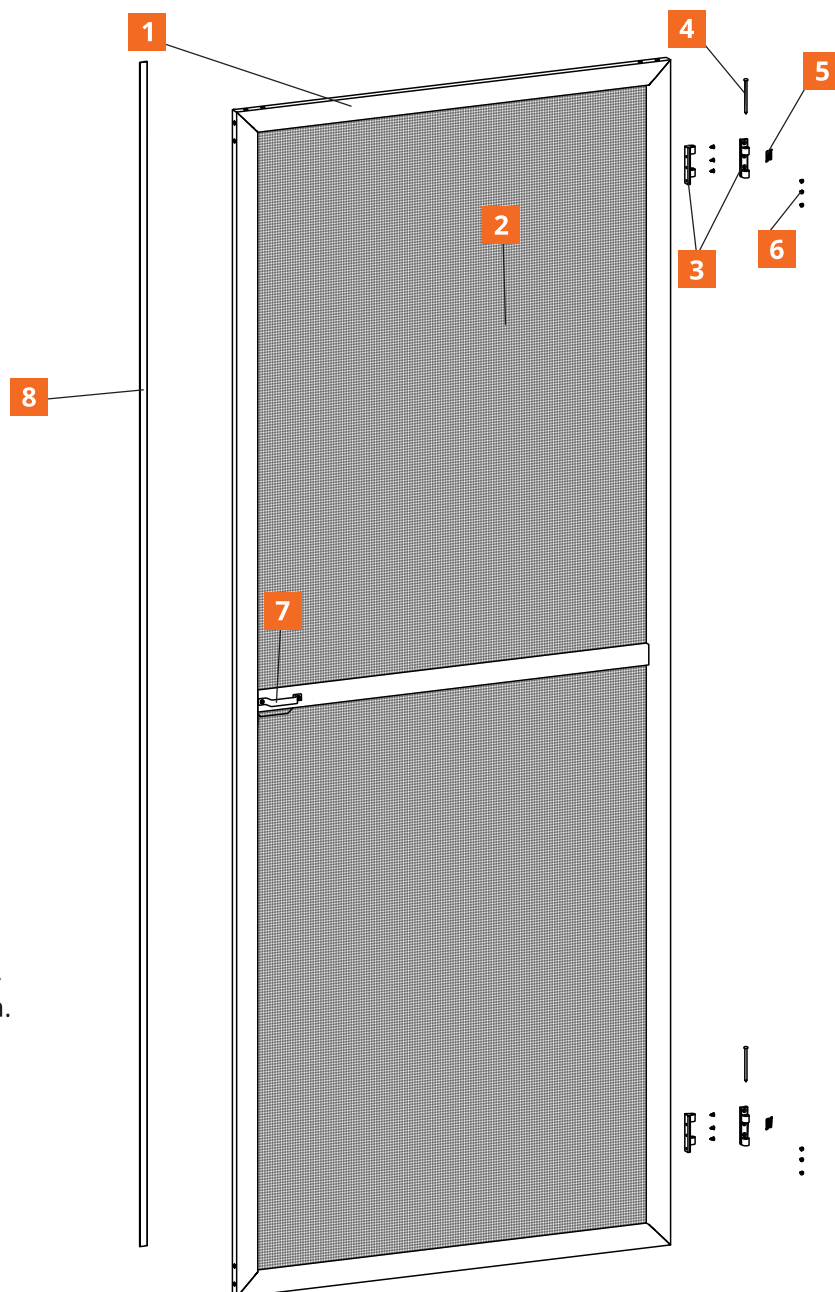

MEASUREMENT:

Two dimensions are necessary for manufacturing a screen-door: width and height of the door.

Width of the door - the measurement should be performed from one angle of the opening to another angle of the opening adding 40 mm to the obtained dimension.

Height of the door - the measurement should be performed from the top angle of the opening to the bottom angle of the opening adding 40 mm to the obtained dimension.

When measuring the height and the width of the opening, one can leave less than 40 mm (10 mm is the least possible lap); however, this is recommended only if the door is in the niche, and there is no possibility to leave 40 mm.

Evaluate the space, so as to leave enough for door hinges. Door hinges protrude 15 mm.

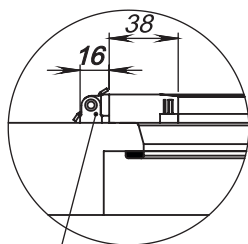
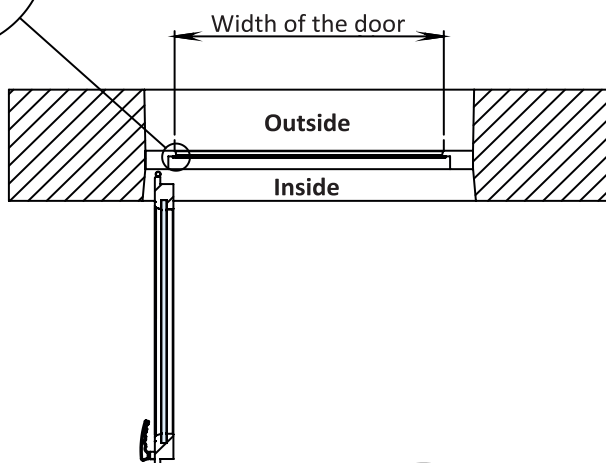
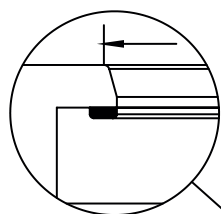
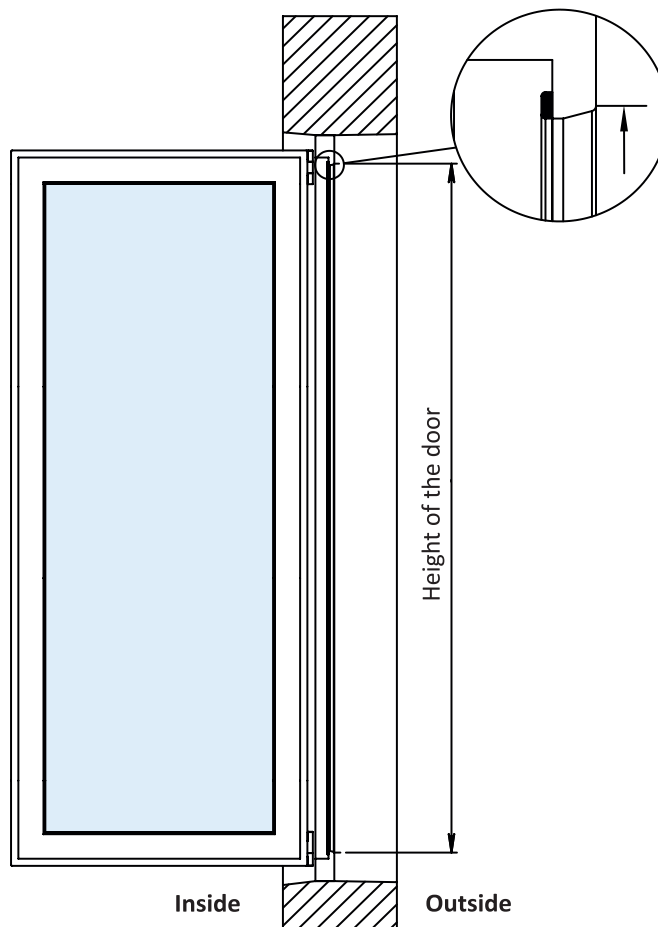

Hinge

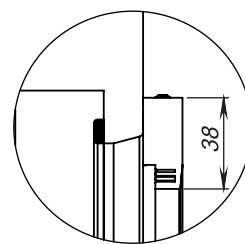
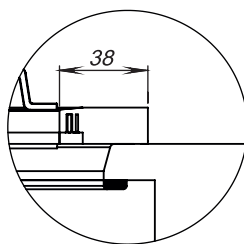

INSTALLATION:

Step 1.

Attach hinges to the aluminum profile of the screen door. Hinges fixed 150 mm from the edge of the door.

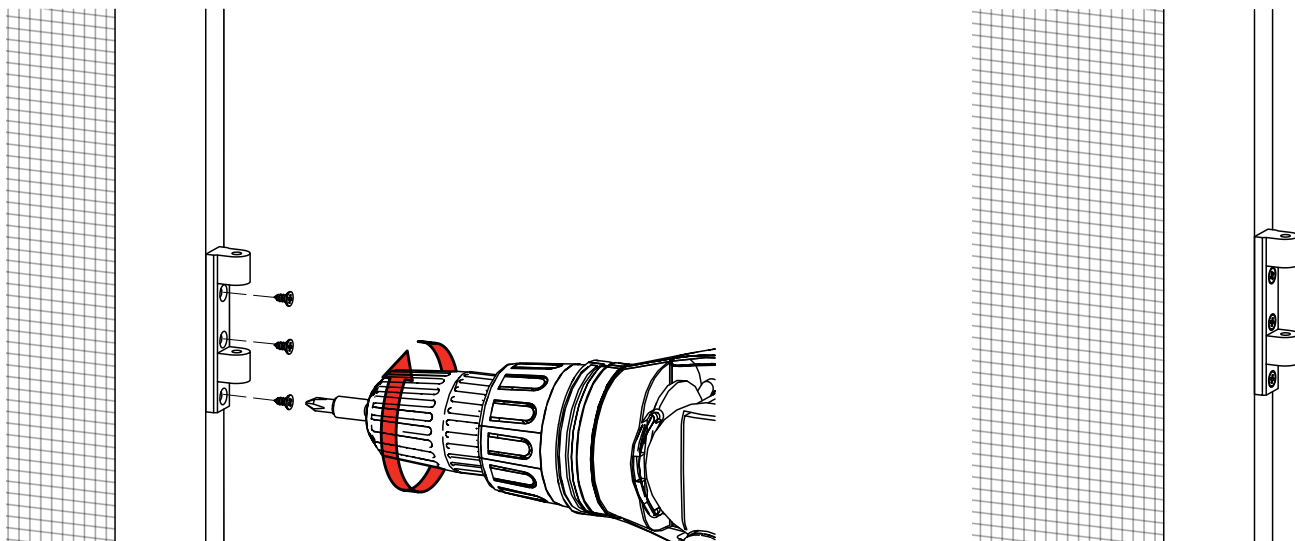

Step 2.

Place the door with the screwed hinges into the door opening, and mark the spot for the hinges on another side. Fasten the hinges to the door frame or to the wall.

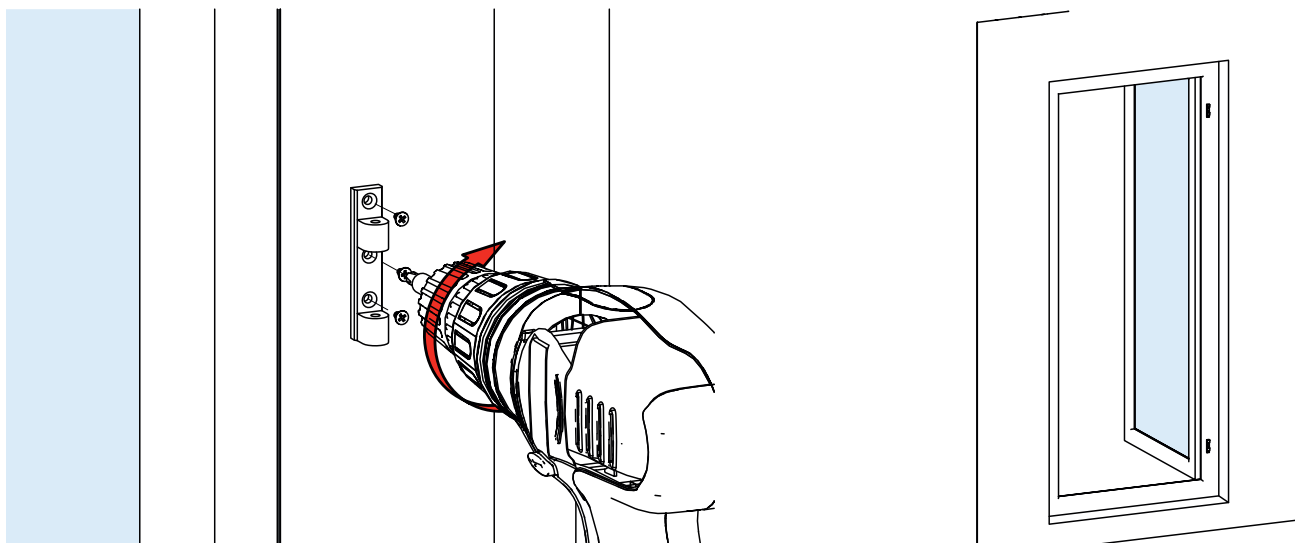

SCREEN DOOR

MEASUREMENT & INSTALLATION

INSTRUCTIONS

Step 3.

Press hinges, and after placing springs, insert hinge pins.

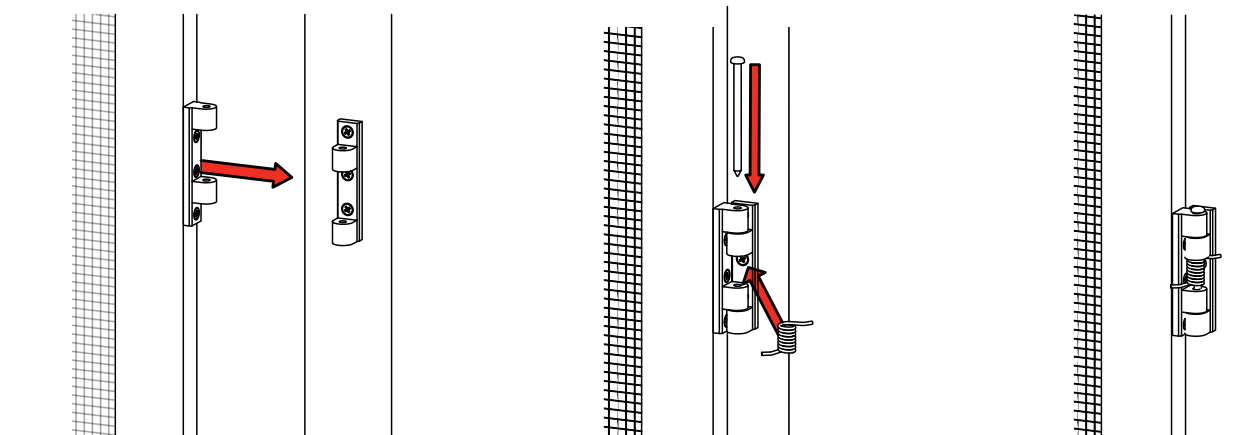

Step 4.

Glue the magnet band onto the door frame, so that after closing the screen, it would draw nearer.

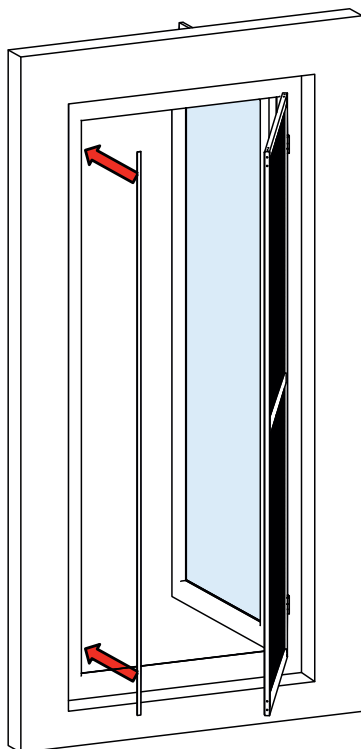

Step 5.

Test the mounted product.

