

SCREEN ROLLER BLINDS FOR WINDOWS

MEASUREMENT & INSTALLATION INSTRUCTIONS

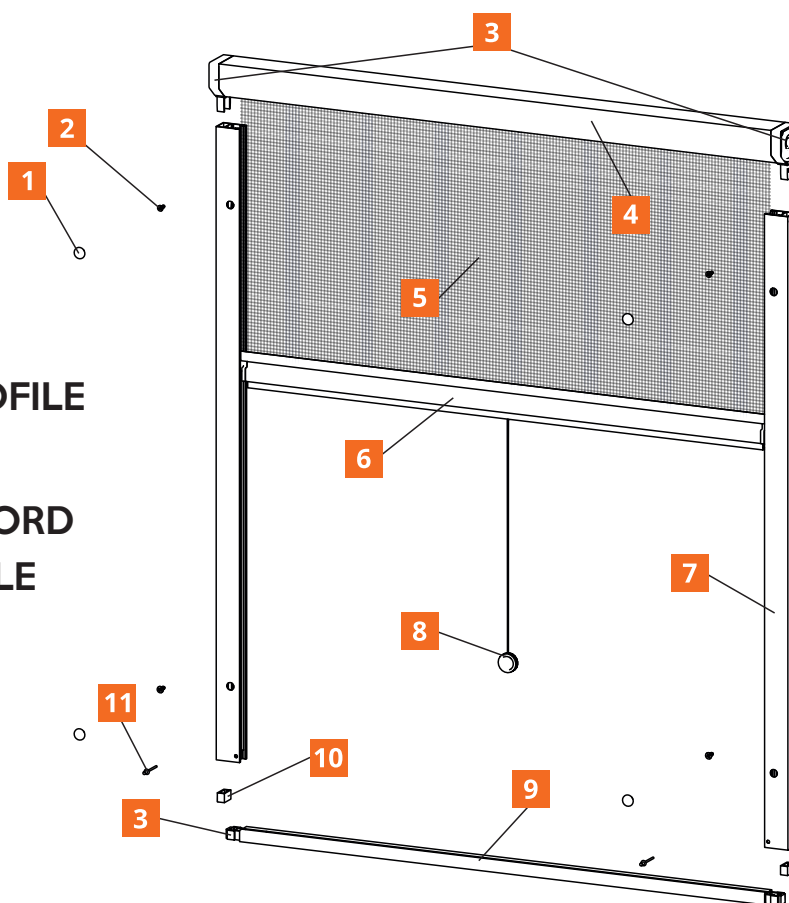

- 1 PLASTIC CAPS**
- 2 SCREWS**
- 3 CONTROL MECHANISM**
- 4 SCREEN CASSETTE**
- 5 SCREEN**
- 6 SLIDING ALUMINUM PROFILE**
- 7 GUIDES**
- 8 AUXILIARY CONTROL CORD**
- 9 LOWER FIXATION PROFILE**
- 10 GUIDE CAP**
- 11 CLINCH**



PRODUCT FEATURES:

Minimum width of the screen-roller blind is 300 mm.
Maximum width of the screen-roller blind is 1600 mm.

SCREEN ROLLER BLIND FOR WINDOWS

MEASUREMENT & INSTALLATION INSTRUCTIONS

MEASUREMENT:

Two dimensions are necessary for measuring a screen-roller blind for windows:

Height of the screen-roller blind – height of the window opening from the lower edge of the opening to the upper edge of the opening is measured and indicated adding 64 mm.

Width of the screen-roller blind – width of the window opening from one edge of the opening to another edge of the opening is measured and indicated adding 64 mm.

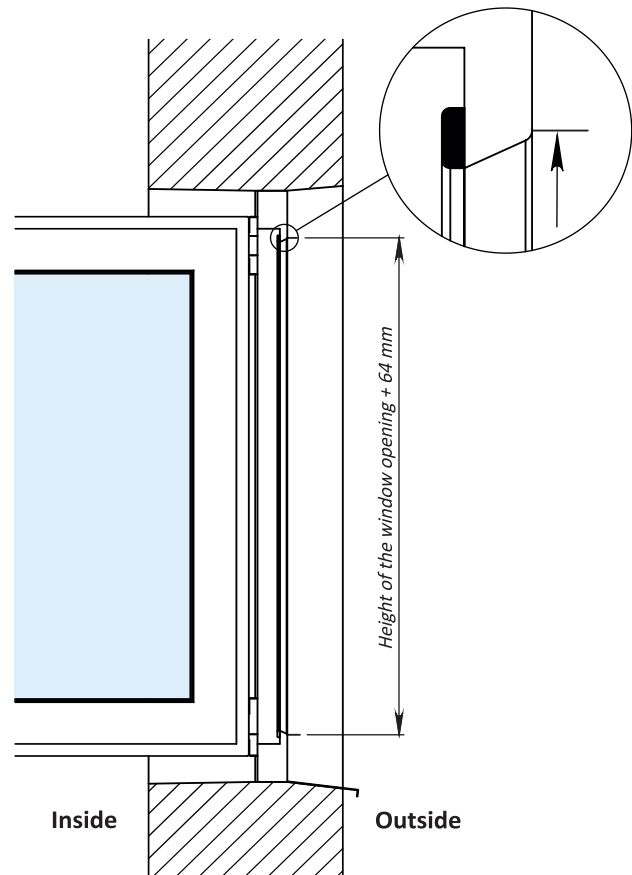
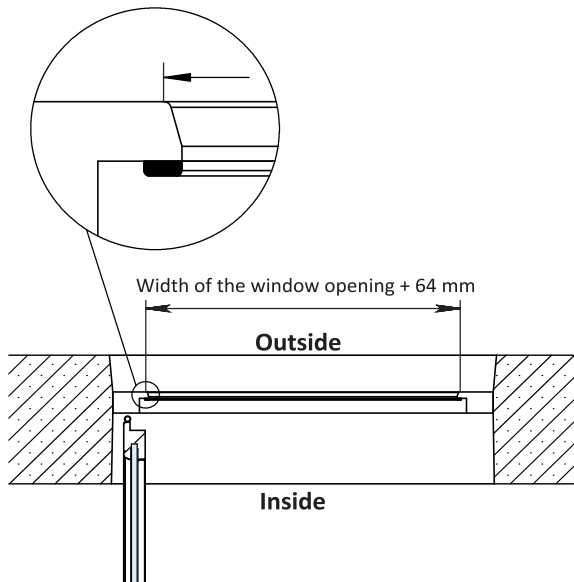

! During measurement, evaluate whether there is enough space for the cassette of the screen-roller blind and guides around the window opening.

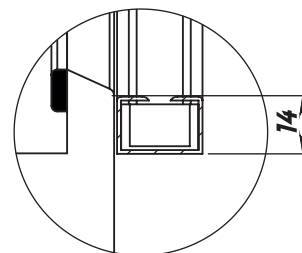
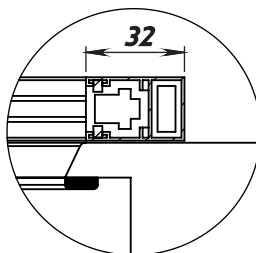
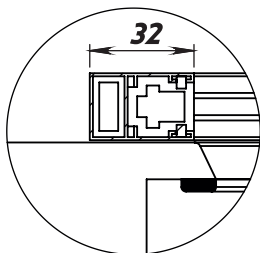
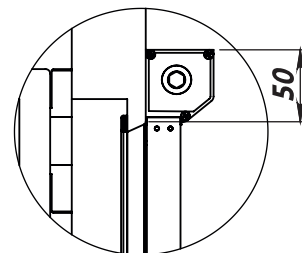

INSTALLATION:

Step 1.

Connect side guides with the cassette of the screen-roller blind.

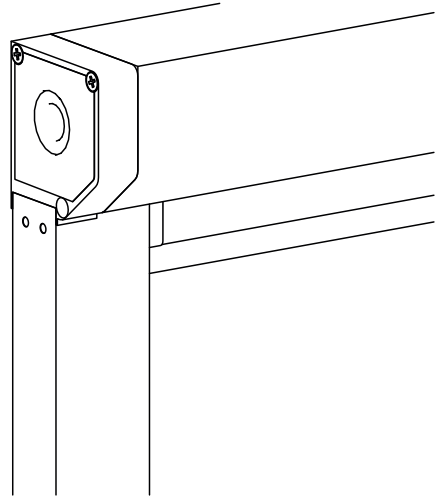
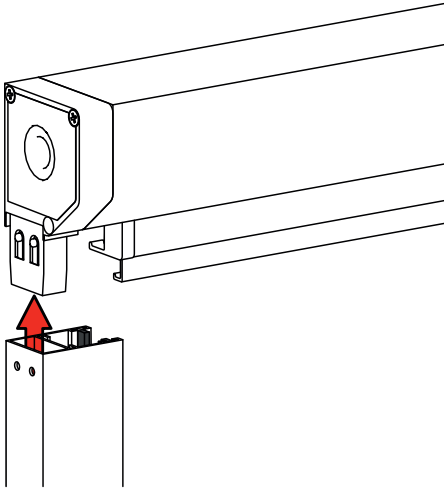

In one of the ends of the side guide, two holes are screwed. That end of the guide is connected to the cassette and is locked.

Step 2.

Insert the lower fixation profile into side guides.

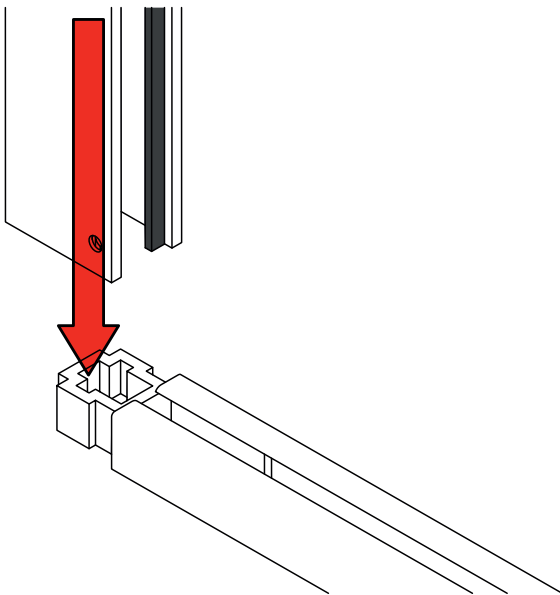

SCREEN ROLLER BLIND FOR WINDOWS

MEASUREMENT & INSTALLATION INSTRUCTIONS

Step 3.

Screw through the side guides by means of 4.1 mm drill (there are 4 mm clinches are included in the package) and fasten with clinches.

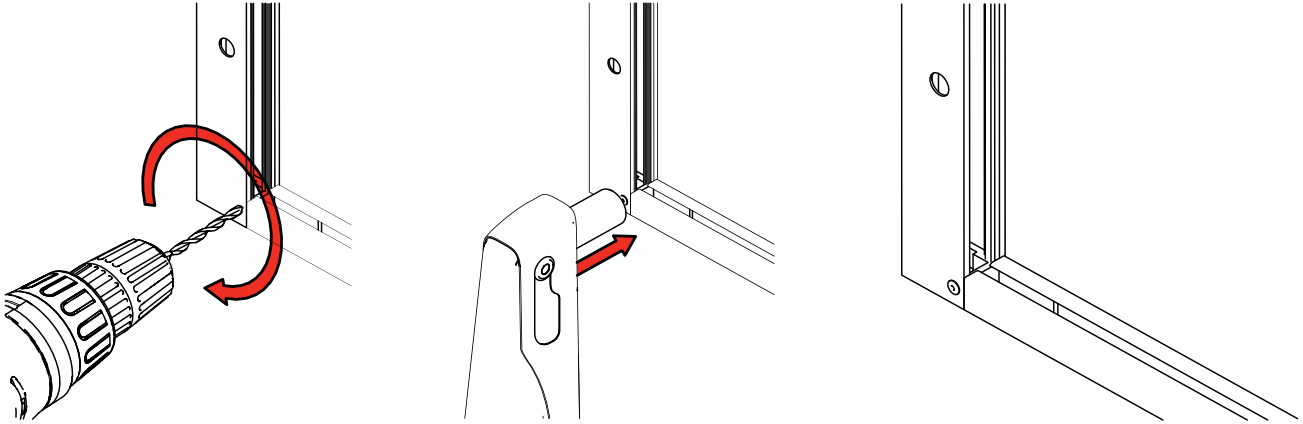

Step 4.

Place the caps on the ends of the guides.



Step 5.

Place the assembled frame of the screen to the window so that the guides would not cover the door opening.

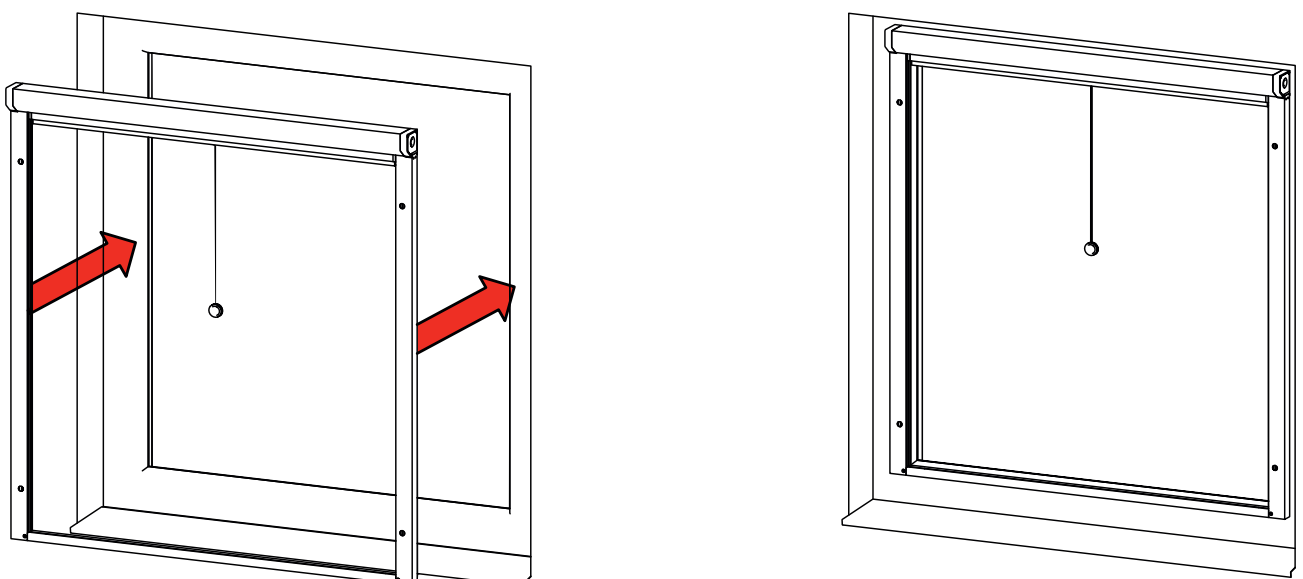

SCREEN ROLLER BLIND FOR WINDOWS

MEASUREMENT & INSTALLATION INSTRUCTIONS

Step 6.

Screw the screen-roller blind onto the window frame. Place plastic caps into the holes.

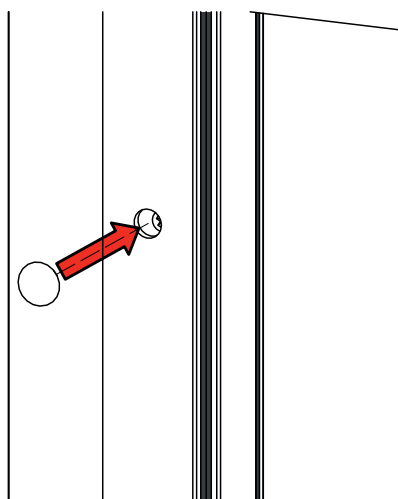
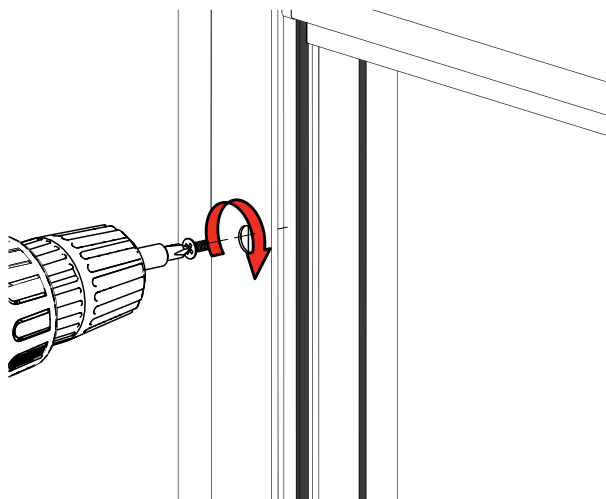

Step 7.

Test the mounted screen-roller blind for the windows.

